

**THRASHER OPERA HOUSE  
VENUE & TECH INFORMATION**



THRASHER  
OPERA HOUSE  
GREEN LAKE, WISCONSIN

**2025**

*Monday, April 28, 2025*



**Address:**

Thrasher Opera House  
506 Mill Street • PO Box 4  
Green Lake, Wisconsin 54941  
[info@thrasheroperahouse.com](mailto:info@thrasheroperahouse.com)

**Telephone:**

Primary Phone Number: 920.294.4279  
[REDACTED]  
[REDACTED]

**Personnel:**

Executive Director: Rachael Avery	<a href="mailto:rachael@thrasheroperahouse.com">rachael@thrasheroperahouse.com</a>
Production Manager: Riley Icenogle	<a href="mailto:thinicesound@gmail.com">thinicesound@gmail.com</a>
Marketing Director: Jason Mansmith	<a href="mailto:jason@thrasheroperahouse.com">jason@thrasheroperahouse.com</a>
Development Director: Katie Menting	<a href="mailto:katie@thrasheroperahouse.com">katie@thrasheroperahouse.com</a>
Box Office & Events Manager: Kayla Reeves	<a href="mailto:kayla@thrasheroperahouse.com">kayla@thrasheroperahouse.com</a>

**Load-In/Parking**

Load-in occurs in the Thrasher Opera House parking lot on the Northside of the building. Utilize the Wheelchair Accessible Parking stall to unload. Move the vehicle to any other spot in the lot after complete load-in. Door size is a standard 80"x36" entry door. Distance from door to stage is approximately 25'. A hand hydraulic lift is available for heavy items to lift on to the stage.



**Dressing Rooms/Green Room/Performers Restroom**

Rooms are located via the stage left staircase to the lower level. Temperature-controlled rooms include one common area, one dressing room, one green room (with sink, refrigerator, coffee pot & tea kettle), and one private bathroom. An iron and ironing board are available, along with many full-length mirrors. There are several garbage receptacles in the space as well.

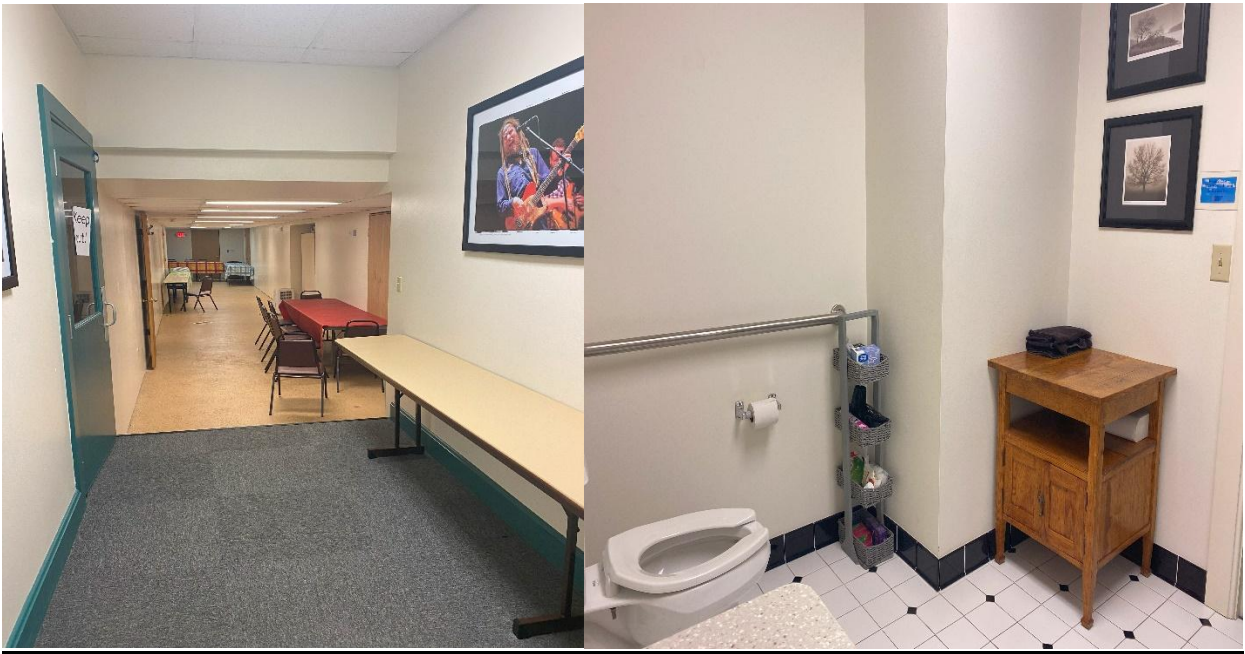



## **WIFI**

In the lower level, we have two (2) networks.

[REDACTED]

In the performance space, we have two (2) networks

[REDACTED]

## **Social Media**

Facebook: @thrasheroperahouse

Instagram: @thrasheroperahouse

Spotify: thrashergreenlake

Hashtags: #thrasheroperahouse

## **Merchandise**

The merchandise area is in the rear of the venue. The site is high traffic. We have two 6' tables set up. Please let us know if you need to ship merchandise to the venue and use the following address. Thrasher Opera House 506 Mill Street Green Lake WI 54941. We do provide personnel to sell merchandise show evening. We typically utilize a 85/15 split for merch in our contracts. Please let us know if you will accept cash/checks/cards.

## **Stage Dimensions**

Width (inside the proscenium)	24'
Depth (depth without thrust)	16'
Depth (depth with thrust)	19'

## **Stage Draperies**

- 1 - Grand Drape Red - Stage Right Pulley
- 1 - Back Curtain Black - Stage Right Pulley
- 1 - White Wall - Stationary

## **Audio System**

Control/Playback (FOH)

- 1 - Allen & Heath SQ7 32 input/16 output
- 1 - Snake 32x8 (various drop snakes available)
- 6 - Passive Aux Mixes for monitors (we can accommodate in-ear mixes)

Loudspeakers (FOH) (2018 Install)

- 2 - Danley SM96 Flown
- 2 - Initial Sound Custom Subs



### Stage Monitors

- 8 - Turbosound – TFM 122-M (wedge)
- 1 - Electro-Voice ELX118P Subwoofer
- 1 - Electro-Voice ELX112P Powered Speaker

### Various Mics, DI's, Stands & Cables

1/8" plug is available for phones/tablets/computer/mp3 players  
We can accommodate Spotify playlists

### **Lighting System (See Light Plot Below)**

#### Control

- 1 – ETC ColorSource 40AV (2022 Install)
- 1 – Strand MX (Not in use)

#### Dimming

- 1 – ETC Echo Relay Panel (2022 Install)
  - 120/208V 3P 4W+G MLO includes 12 1-pole relays & 12 1-pole breakers

### **Lighting Inventory (See Light Plot Below)**

#### Balcony/FOH

- 6 – ETC ColorSource LED 14° barrel (w/diffuser) 5 pin DMX (2022 install)

#### Stage {3 Electrics}

- 9 – ETC ColorSource LED (w/diffuser) 5 pin DMX (2022 install)

#### Cyc

- 4 – ETC ColorSource Cyc LED 5 pin DMX (2022 install)

#### Moving Heads

- 4 – Chauvet Professional Maverick Force S Spot 5 pin DMX (2022 install)

#### Spotlights

- 2 - Lycian Midget 2K 1907

### **Enviromentals**

- Chauvet Professional – Amhaze ECO Pro Haze Machine (2023 Install)

### **Projection**

- Panasonic PT-MZ780BU7 (2024 Install)
- Epson Power Lite 775F4 Ultra Short Throw Projector (2025 Install)

### **Backline**

#### Drums

- Yamaha Stage Custom
- Bass drum 22"
- Snare 14"
- Toms 12" & 14"



### Cymbals

Zildjian A Custom Set  
Hi Hat 14"  
Crash 16" & 18"  
Medium Ride 20"  
Zildjian Ping ride 20"  
Zildjian Thin Crash 17"

### Cajons

LP Black Box  
On Stage Fixed Snare (has adjustment key)

### Piano

Steinway Grand, Model B (7')  
Upright Piano on Opera House Floor  
Yamaha P-525 88-key Digital Piano

### Keyboards

NORD-Electro 6D-73 with Moog EP3-Universal Polarity Expression Pedal

### Amplifiers

SWR Black Beauty Bass Combo (400W)  
Fender Deluxe Combo  
Fender VibroLux Combo

### Miscellaneous

Guitar Stands  
Amp Tip ups





# Lighting Plot

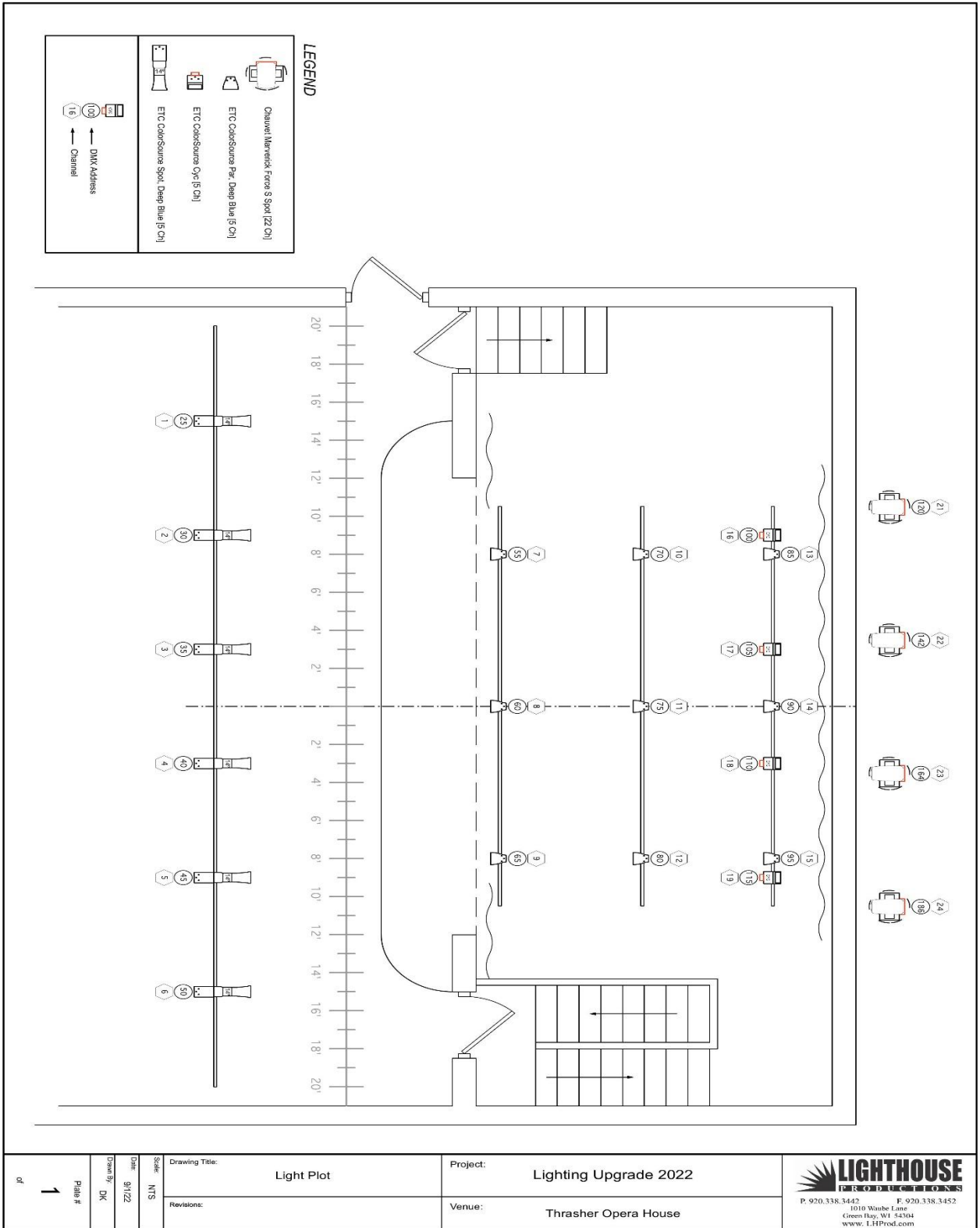

Drawing Title: <b>Light Plot</b>	Project: <b>Lighting Upgrade 2022</b>	 P. 920.338.3442 F. 920.338.3452 1010 Waube Lane Greens Bay, WI 54304 www.LHPProd.com
Revisions:	Venue: <b>Thrasher Opera House</b>	
Date: 9/1/22		
Drawn By: DK		
Plate # <b>1</b>		
of		



## Parking Information

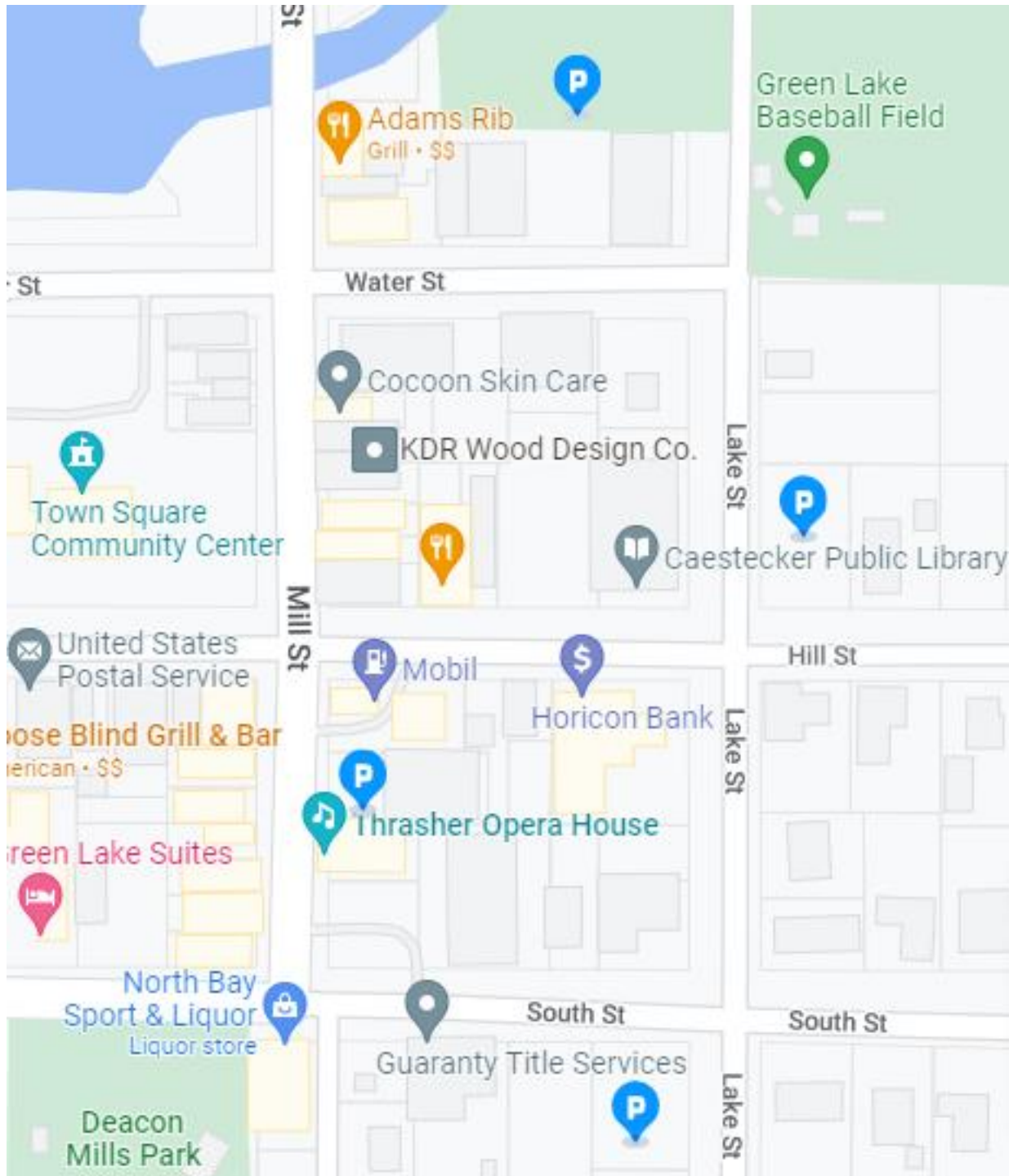





### **Historical Notes & Information**

- Space was originally built in 1910 by Charlie Thrasher, for local performances, vaudeville theater, and silent movies.
- Underwent a major renovation and re-opened in 1998.
- Our facility is listed on the National Historic Site registry.
- Seats 200

### **Accommodations & Services**

Heidel House - 1.3 miles to Thrasher  
653 Illinois Ave. Green Lake, WI 54941 920.807.0300

### **Police**

Emergency 911 or 920.294.6333  
AED located in Box Office at front of Opera House

### **Hospital**

Ripon Community Hospital – 845 Parkside St. Ripon, WI 54971  
ThedaCare Medical Center – 225 Memorial Dr. Berlin, WI 54923



# THRASHER OPERA HOUSE EMERGENCY EXITS

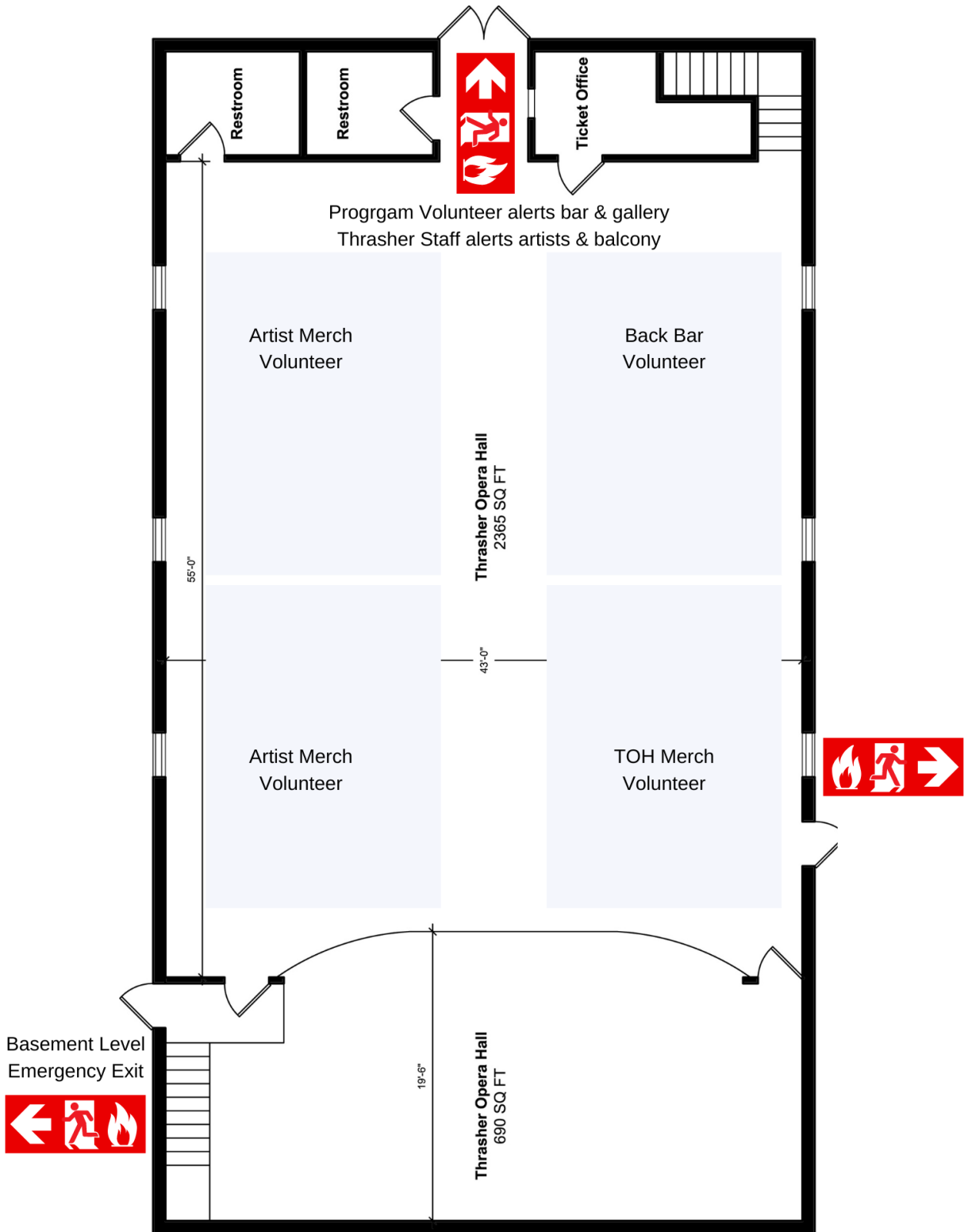



# Emergency Route to Deacon Mills Park from Thrasher Opera House

