

THRASHER OPERA HOUSE VENUE & TECH INFORMATION



THRASHER
OPERA HOUSE
GREEN LAKE, WISCONSIN

2025

Monday, August 11, 2025

**Address:**

Thrasher Opera House
506 Mill Street • PO Box 4
Green Lake, Wisconsin 54941
info@thrasheroperahouse.com

Telephone:

Primary Phone Number: 920.294.4279

**Personnel:**

Executive Director: Rachael Avery
Production Manager: Riley Icenogle
Marketing Director: Jason Mansmith
Box Office & Events Manager: Kayla Reeves

rachael@thrasheroperahouse.com
thinicesound@gmail.com
jason@thrasheroperahouse.com
kayla@thrasheroperahouse.com

Load-In/Parking

Load-in occurs in the Thrasher Opera House parking lot on the Northside of the building. Utilize the Wheelchair Accessible Parking stall to unload. Move the vehicle to any other spot in the lot after complete load-in. Door size is a standard 80"x36" entry door. Distance from door to stage is approximately 25'. A hand hydraulic lift is available for heavy items to lift on to the stage.

**Dressing Rooms/Green Room/Performers Restroom**

Rooms are located via the stage left staircase to the lower level. Temperature-controlled rooms include one common area, one dressing room, one green room (with sink, refrigerator, coffee pot & tea kettle), and one private bathroom. An iron and ironing board are available, along with many full-length mirrors. There are several garbage receptacles in the space as well.





WIFI

In the lower level, we have two (2) networks.

[REDACTED]

In the performance space, we have two (2) networks

[REDACTED]

Social Media

Facebook: @thrasheroperahouse

Instagram: @thrasheroperahouse

Spotify: thrashergreenlake

Hashtags: #thrasheroperahouse

Merchandise

The merchandise area is in the rear of the venue. The site is high traffic. We have two 6' tables set up. Please let us know if you need to ship merchandise to the venue and use the following address. Thrasher Opera House 506 Mill Street Green Lake WI 54941. We do provide personnel to sell merchandise show evening. We typically utilize a 85/15 split for merch in our contracts. Please let us know if you will accept cash/checks/cards.

Stage Dimensions

Width (inside the proscenium)	24'
Depth (depth without thrust)	16'
Depth (depth with thrust)	19'

Stage Draperies

- 1 - Grand Drape Red - Stage Right Pulley
- 1 – Back Curtain Black – Stage Right Pulley
- 1 – White Wall - Stationary

Audio System

Control/Playback (FOH)

- 1 - Allen & Heath SQ7 32 input/16 output
- 1 – Snake 32x8 (various drop snakes available)
- 6 – Passive Aux Mixes for monitors (we can accommodate in-ear mixes)

Loudspeakers (FOH) (2018 Install)

- 2 - Danley SM96 Flown
- 2 – Initial Sound Custom Subs



Stage Monitors

- 8 - Turbosound – TFM 122-M (wedge)
- 1 - Electro-Voice ELX118P Subwoofer
- 1 - Electro-Voice ELX112P Powered Speaker

Various Mics, DI's, Stands & Cables

1/8" plug is available for phones/tablets/computer/mp3 players

We can accommodate Spotify playlists

Lighting System (See Light Plot Below)

Control

- 1 – ETC ColorSource 40AV (2022 Install)
- 1 – Strand MX (Not in use)

Dimming

- 1 – ETC Echo Relay Panel (2022 Install)
 - 120/208V 3P 4W+G MLO includes 12 1-pole relays & 12 1-pole breakers

Lighting Inventory (See Light Plot Below)

Balcony/FOH

- 6 – ETC ColorSource LED 14° barrel (w/diffuser) 5 pin DMX (2022 install)

Stage {3 Electrics}

- 9 – ETC ColorSource LED (w/diffuser) 5 pin DMX (2022 install)

Cyc

- 4 – ETC ColorSource Cyc LED 5 pin DMX (2022 install)

Moving Heads

- 4 – Chauvet Professional Maverick Force S Spot 5 pin DMX (2022 install)

Spotlights

- 2 - Lycian Midget 2K 1907

Enviromentals

Chauvet Professional – Amhaze ECO Pro Haze Machine (2023 Install)

Projection

Panasonic PT-MZ780BU7 (2024 Install)

Epson Power Lite 775F4 Ultra Short Throw Projector (2025 Install)

Backline

Drums

Yamaha Stage Custom

Bass drum 22"

Snare 14"

Toms 12" & 14"



Cymbals

Zildjian A Custom Set

Hi Hat 14"

Crash 16" & 18"

Medium Ride 20"

Zildjian Ping ride 20"

Zildjian Thin Crash 17"

Caions

LP Black Box

On Stage Fixed Snare (has adjustment key)

Piano

Steinway Grand, Model B (7')

Upright Piano on Opera House Floor

Yamaha P-525 88-key Digital Piano

Keyboards

NORD-Electro 6D-73 with Moog EP3-Universal Polarity Expression Pedal

Amplifiers

SWR Black Beauty Bass Combo (400W)

Fender Deluxe Combo

Fender VibroLux Combo

Miscellaneous

Guitar Stands

Amp Tip ups

Lighting Plot

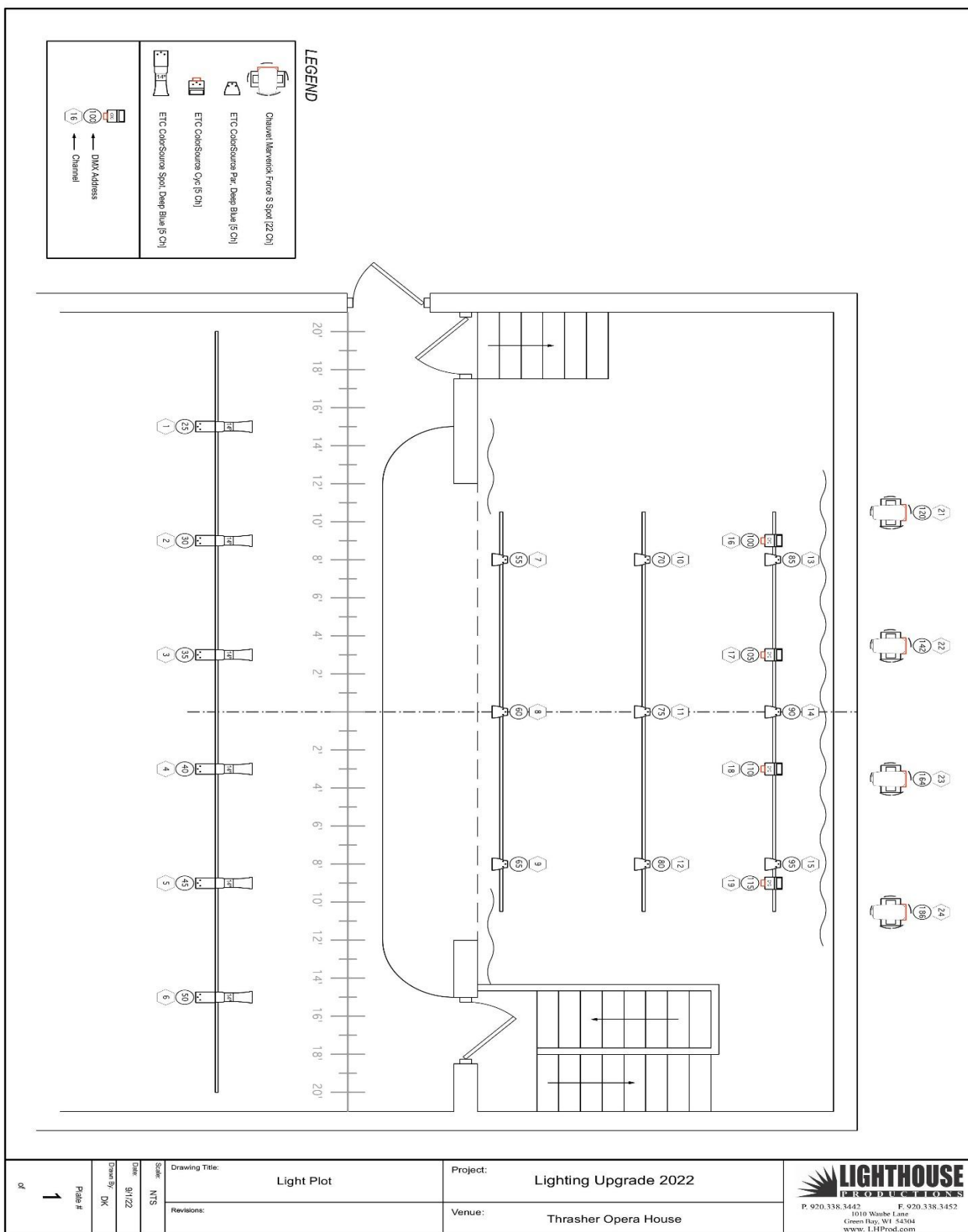



Parking Information

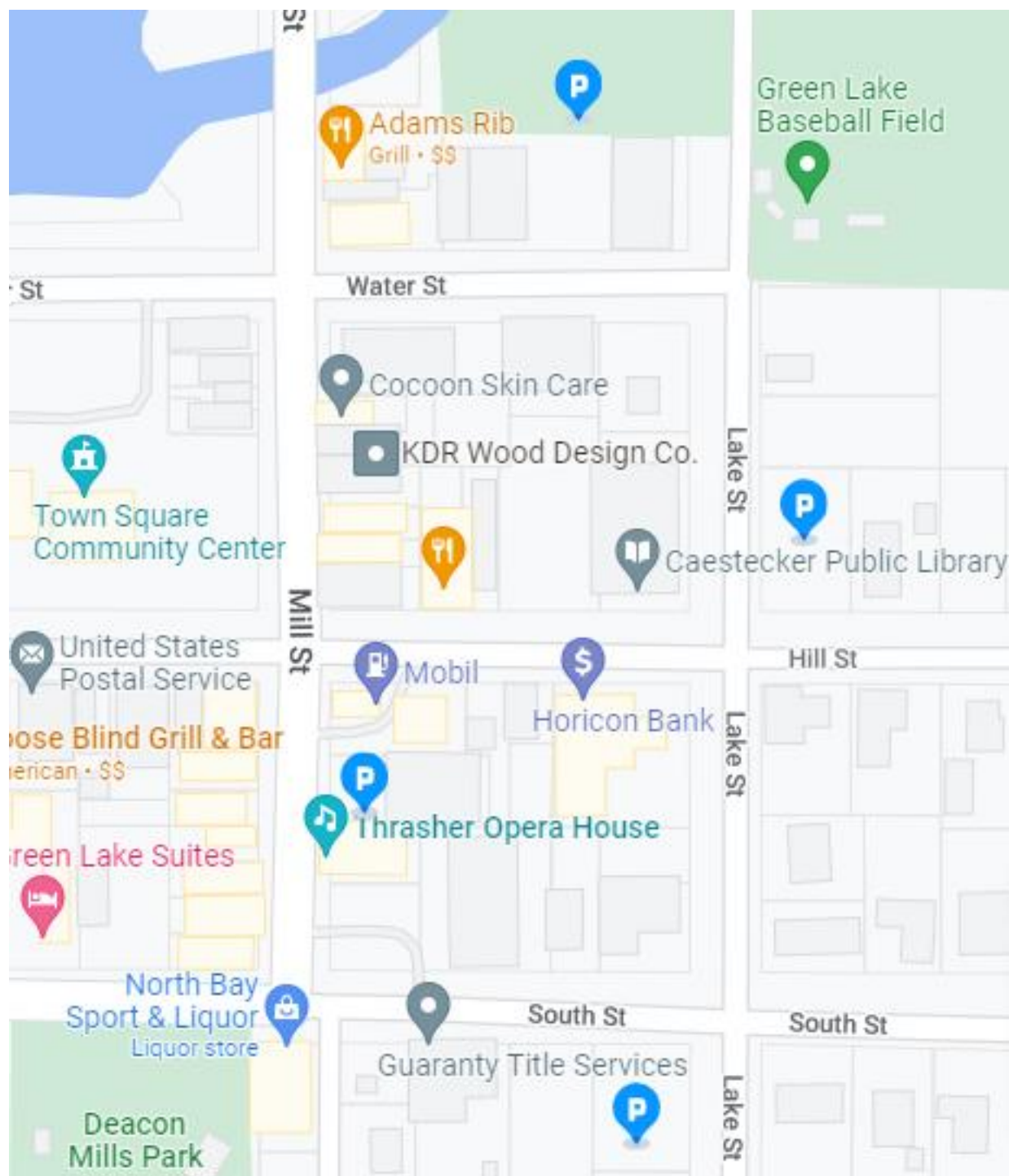



Historical Notes & Information

- Space was originally built in 1910 by Charlie Thrasher, for local performances, vaudeville theater, and silent movies.
- Underwent a major renovation and re-opened in 1998.
- Our facility is listed on the National Historic Site registry.
- Seats 200

Accommodations & Services

Heidel House - 1.3 miles to Thrasher

653 Illinois Ave. Green Lake, WI 54941 920.807.0300

Police

Emergency 911 or 920.294.6333

AED located in Box Office at front of Opera House

Hospital

Ripon Community Hospital – 845 Parkside St. Ripon, WI 54971

ThedaCare Medical Center – 225 Memorial Dr. Berlin, WI 54923



THRASHER OPERA HOUSE EMERGENCY EXITS

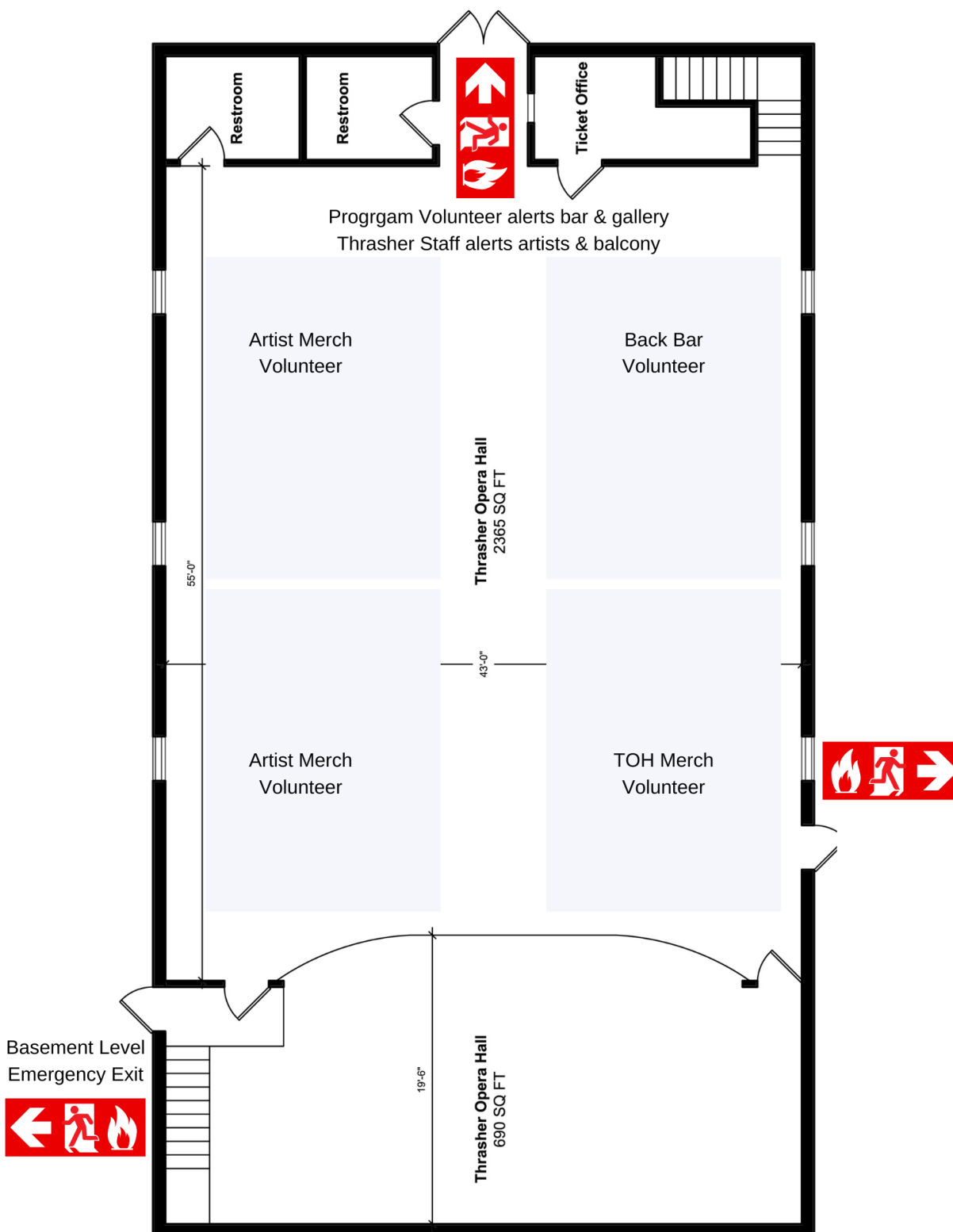



Emergency Route to Deacon Mills Park from Thrasher Opera House

