

THRASHER OPERA HOUSE VENUE & TECH INFORMATION



THRASHER
OPERA HOUSE
GREEN LAKE, WISCONSIN

2024

Wednesday, March 20, 2024

**Address:**

Thrasher Opera House
506 Mill Street • PO Box 4
Green Lake, Wisconsin 54941
info@thrasheroperahouse.com

Telephone:

Primary Phone Number: 920.294.4279
[REDACTED]
[REDACTED]

Personnel:

Executive Director: Rachael Avery	rachael@thrasheroperahouse.com
Production Manager: Riley Icenogle	thinicesound@gmail.com
Marketing Director: Jason Mansmith	jason@thrasheroperahouse.com
Development Director: Katie Menting	katie@thrasheroperahouse.com
Box Office & Events Manager: Kayla Reeves	kayla@thrasheroperahouse.com

Load-In/Parking

Load-in occurs in the Thrasher Opera House parking lot on the Northside of the building. Utilize the Wheelchair Accessible Parking stall to unload. Move the vehicle to any other spot in the lot after complete load-in. Door size is a standard 80"x36" entry door. Distance from door to stage is approximately 25'. A hand hydraulic lift is available for heavy items to lift on to the stage.

Dressing Rooms/Green Room/Performers Restroom

Rooms are located via the stage left staircase to the lower level. Temperature-controlled rooms include one common area, one dressing room, one green room (with sink, refrigerator, coffee pot & tea kettle), and one private bathroom. An iron and ironing board are available, along with many full-length mirrors. There are several garbage receptacles in the space as well.

WIFI

[REDACTED]
[REDACTED]
[REDACTED]

[REDACTED]
[REDACTED]
[REDACTED]

Social Media

Facebook: @thrasheroperahouse
Instagram: @thrasheroperahouse
Spotify: thrashergreenlake
Hashtags: #thrasheroperahouse



Merchandise

The merchandise area is in the rear of the venue. The site is high traffic. We have two 6' tables set up. Please let us know if you need to ship merchandise to the venue and use the following address. Thrasher Opera House 506 Mill Street Green Lake WI 54941. We do provide personnel to sell merchandise show evening. We would be grateful if you'd like to donate some back to the house, as we are a nonprofit venue. However, we understand if that is not possible. Please let us know if you will accept cash/checks/cards.

Stage Dimensions

Width (inside the proscenium)	24'
Depth (depth without thrust)	16'
Depth (depth with thrust)	19'

Stage Draperies

- 1 - Grand Drape Red - Stage Right Pulley
- 1 – Back Curtain Black – Stage Right Pulley
- 1 – White Wall - Stationary

Audio System

Control/Playback (FOH)

- 1 - Allen & Heath SQ7 32 input/16 output
- 1 – Allen & Heath GL2800 32 input/8 output
- 6 – Aux Mixes for monitors (we can accommodate in-ear mixes)
- 1 – Snake 32x8 (various drop snakes available)
- 1 – TC Electronic M 3000
- 1 – TC Electronic M ONE
- 1 – Darwarmer DL441
- 1 – BSS DPR 422
- 1 – BSS DPR 944
- 1 – APHEX 106
- 2 – DBX 166 XL
- 2 – Symetrix 562E
- 1 – Klark Teknik DN370
- 6 – Yamaha 2031
- 1/8" plug is available for phones/tablets/computer/mp3 players
- We can accommodate Spotify playlists

Loudspeakers (FOH) (2018 Install)

- 2 - Danley SM96 Flown
- 2 – Initial Sound Custom Subs



Stage Monitors

- 8 - Turbosound – TFM 122-M (wedge)
- 1 - Electro-Voice ELX118P Subwoofer
- 1 - Electro-Voice ELX112P Powered Speaker

Microphones

- 5 - Shure SM58
- 4 - Shure SM57
- 4 – Crown CM700
- 4 – Sennheiser E906
- 4 – Shure QLXD Wireless Handheld G50
- 2 – Shure SM86
- 2 – Shure Beta 58
- 2 – Beyerdynamic M88
- 2 – Beyerdynamic M201
- 2 – Beyerdynamic M160
- 2 – Crown PCC160
- 2 - DPA 2028-B-SL1

DI's

- 4 – Countryman DI Boxes (Active DI)
- 2 – Radial JDI (passive)

Cables & Stands & Stage Power

- XLR cables of various lengths
- Microphone stands and booms of various sizes
- AC Stage Power

Lighting System (See Light Plot Below)

Control

- 1 – ETC ColorSource 40AV (2022 Install)
- 1 – Strand MX (Not in use)

Dimming

- 1 – ETC Echo Relay Panel (2022 Install)
 - 120/208V 3P 4W+G MLO includes 12 1-pole relays & 12 1-pole breakers

Lighting Inventory (See Light Plot Below)

Balcony/FOH

- 6 – ETC ColorSource LED 14° barrel (w/diffuser) 5 pin DMX (2022 install)

Stage {3 Electrics}

- 9 – ETC ColorSource LED (w/diffuser) 5 pin DMX (2022 install)

Cyc



4 – ETC ColorSource Cyc LED 5 pin DMX (2022 install)
Moving Heads
4 – Chauvet Professional Maverick Force S Spot 5 pin DMX (2022 install)
Spotlights
2 - Lycian Midget 2K 1907

Enviromentals

Chauvet Professional – Amhaze ECO Pro Haze Machine (2023 Install)

Projection

Panasonic PT-MZ780BU7 with HDMI (2024 Install)
Projection Screen 15'x10' (throw distance 55')

The screen that drops in front of the stage (motorized) controls Stage Right

Back Up
Panasonic PT L6600 UL with VGA
USB-C to VGA Adapter

Backline

Drums

Yamaha Stage Custom
Bass drum 22"
Snare 14"
Toms 12" & 14"

Cymbals

Zildjian A Custom Set
Hi Hat 14"
Crash 16" & 18"
Medium Ride 20"
Zildjian Ping ride 20"
Zildjian Thin Crash 17"

Cajons

LP Black Box
On Stage Fixed Snare (has adjustment key)

Piano

Steinway Grand, Model B (7')
Upright Piano on Opera House Floor

Keyboards



NORD-Electro 6D-73 with Moog EP3-Universal Polarity Expression Pedal

Amplifiers

SWR Black Beauty Bass Combo (400W)

Fender Deluxe Combo

Fender VibroLux Combo

Miscellaneous

Guitar Stands

Amp Tip ups



Lighting Plot

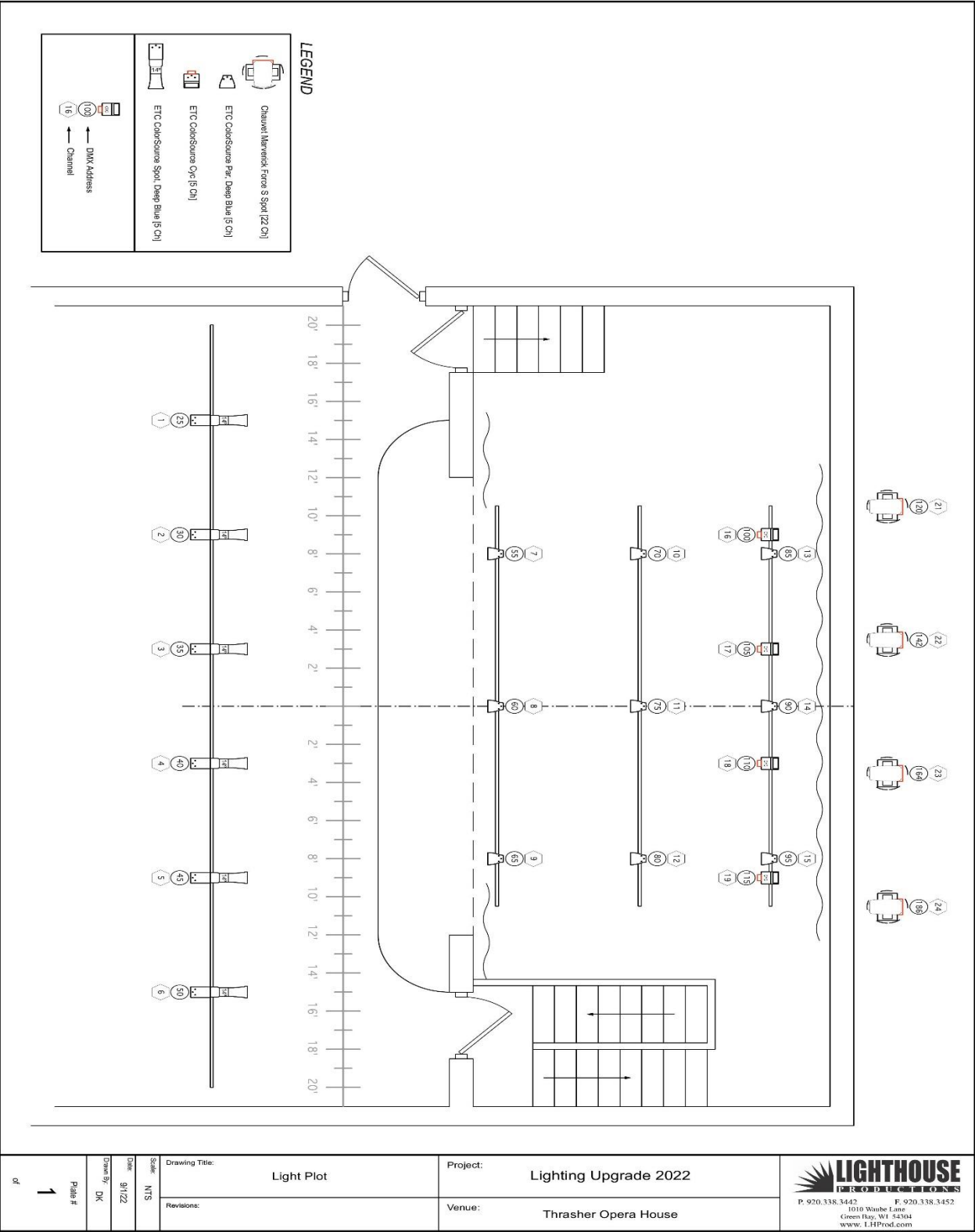



Parking Information

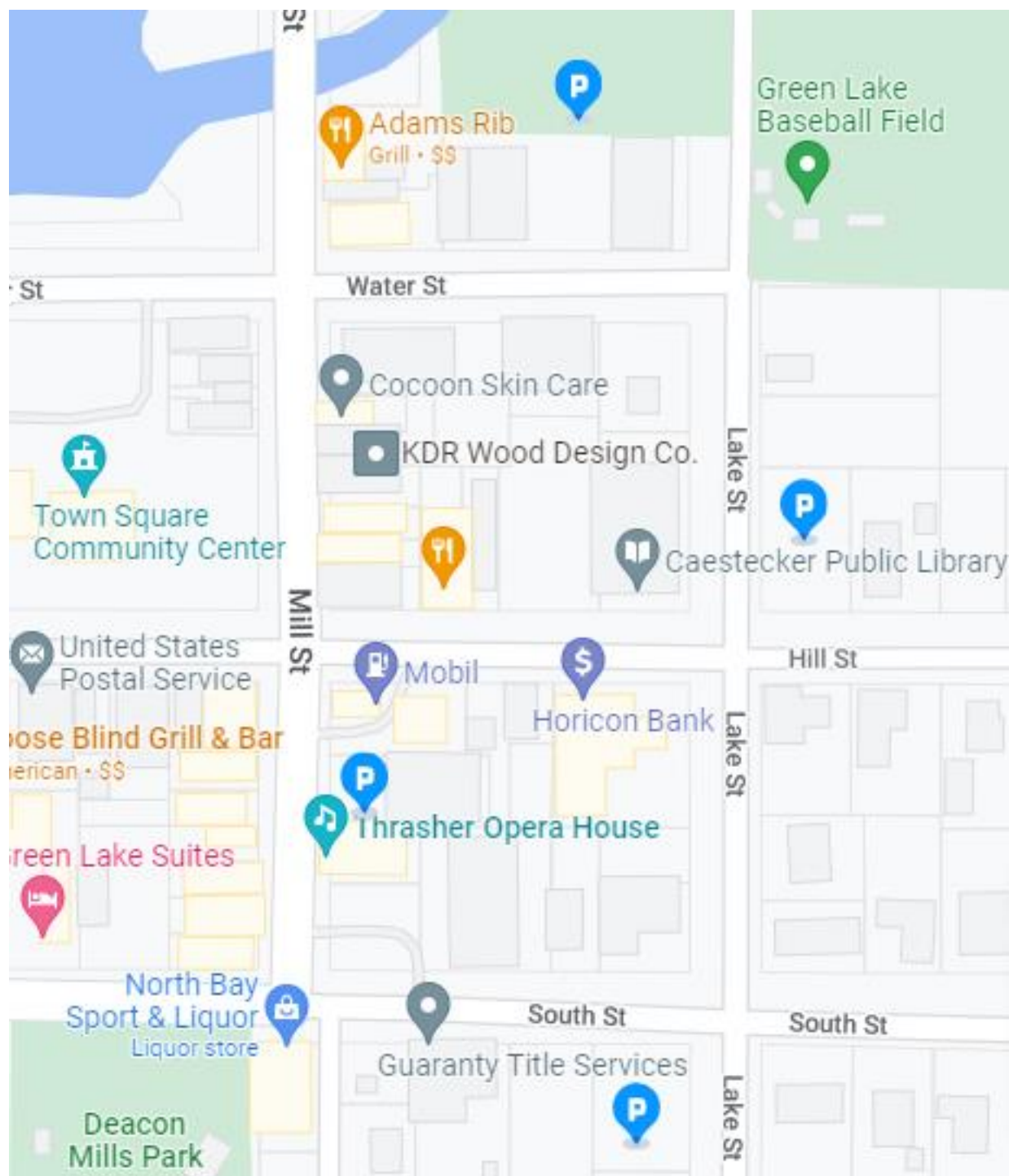



Historical Notes & Information

- Space was originally built in 1910 by Charlie Thrasher, for local performances, vaudeville theater, and silent movies.
- Underwent a major renovation and re-opened in 1998.
- Our facility is listed on the National Historic Site registry.
- Seats 200

Accommodations & Services

Heidel House - 1.3 miles to Thrasher

653 Illinois Ave. Green Lake, WI 54941 920.807.0300

Bayview Motel & Marina – 0.4 miles to Thrasher

439 Lake Street, Green Lake, WI 54971 920.294.6504

Super 8 Motel – 8.3 miles to Thrasher

227 Ripon Road. Berlin, WI 54923 800.454.3509

Police

Emergency 911 or 920.294.6333

Hospital

Ripon Community Hospital – 845 Parkside St. Ripon, WI 54971

ThedaCare Medical Center – 225 Memorial Dr. Berlin, WI 54923



THRASHER OPERA HOUSE EMERGENCY EXITS

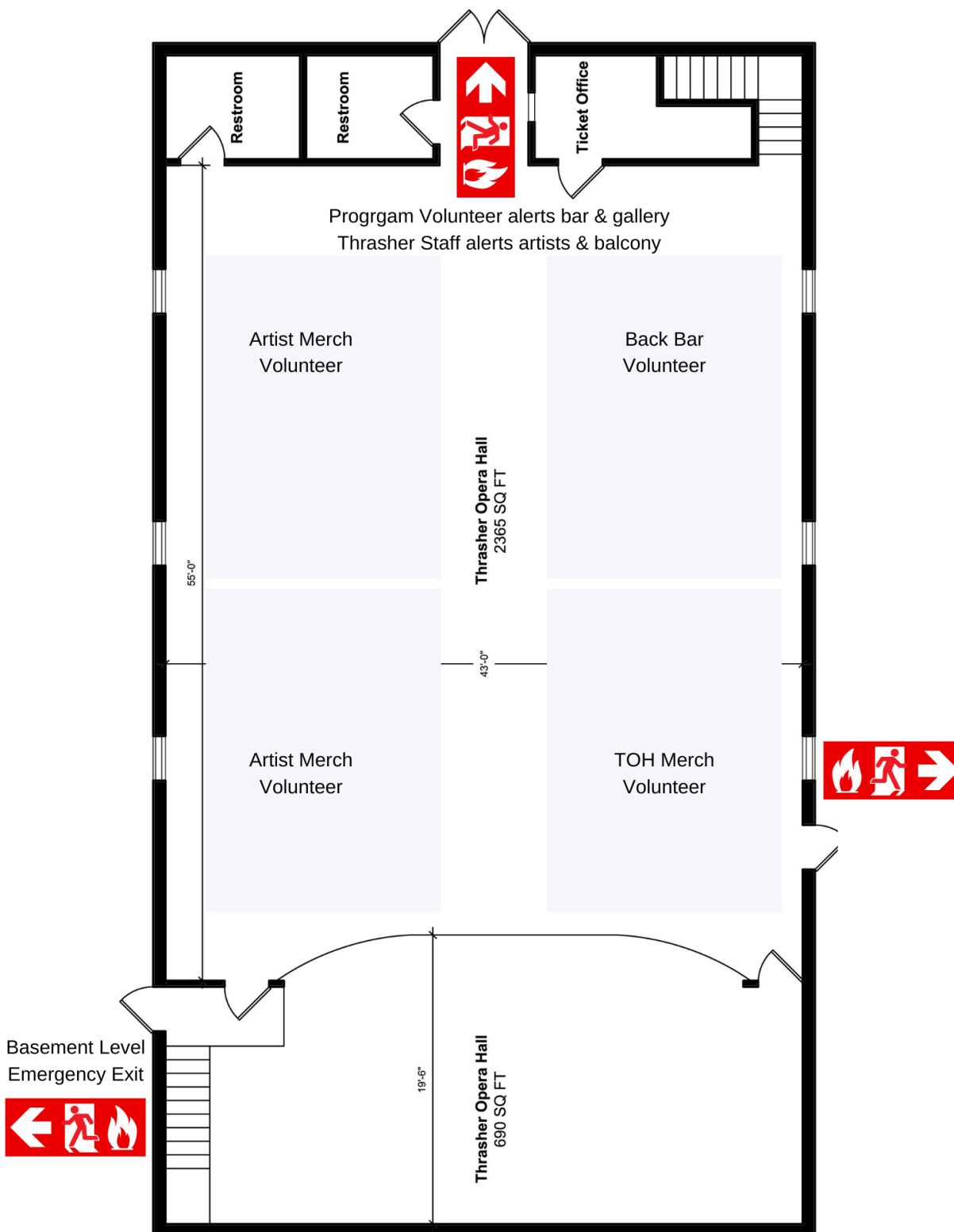



Emergency Route to Deacon Mills Park from Thrasher Opera House

