

THRASHER OPERA HOUSE VENUE & TECH INFORMATION



THRASHER
OPERA HOUSE
GREEN LAKE, WISCONSIN

2023

Monday, June 5, 2023

**Address:**

Thrasher Opera House
506 Mill Street • PO Box 4
Green Lake, Wisconsin 54941
info@thrasheroperahouse.com

Telephone:

Primary Phone Number: 920.294.4279
[REDACTED]
[REDACTED]

Personnel:

Executive Director: Rachael Avery	rachael@thrasheroperahouse.com
Production Manager: Riley Icenogle	thinicesound@gmail.com
Marketing Director: Jason Mansmith	jason@thrasheroperahouse.com
Development Director: Katie Menting	katie@thrasheroperahouse.com
Box Office & Events Manager: Kayla Reeves	kayla@thrasheroperahouse.com

Load-In/Parking

Load-in occurs in the Thrasher Opera House parking lot on the Northside of the building. Utilize the Wheelchair Accessible Parking stall to unload. Move the vehicle to any other spot in the lot after complete load-in. The door size is a standard 80"x36" entry door. Distance from door to stage is approximately 25'. A hand hydraulic lift is available for heavy items to lift onto the stage.

Dressing Rooms/Green Room/Performers Restroom

Rooms are located via the stage left staircase to the lower level. Temperature-controlled rooms include one common area, one dressing room, one green room (with sink, refrigerator, coffee pot & tea kettle), and one private bathroom. An iron and ironing board are available, along with many full-length mirrors. There are several garbage receptacles in the space as well.

WIFI

In the lower level, we have two (2) networks.

TOH_Guest – [REDACTED]

TOH_Greenroom – [REDACTED]

In the performance space, we have two (2) networks

TOH_Guest – [REDACTED]

TOH_Balcony – [REDACTED]

Social Media

Facebook: @thrasheroperahouse

Instagram: @thrasheroperahouse

Spotify: thrashergreenlake



Hashtags: #thrasheroperahouse

Merchandise

The merchandise area is in the rear of the venue. The site is high traffic. We have two 6' tables set up. Please let us know if you need to ship merchandise to the venue and use the following address. Thrasher Opera House 506 Mill Street Green Lake WI 54941. We do provide personnel to sell merchandise show evening. Typically, we do an 85/15 split, with the artist receiving 85% of the profits and 15% to Thrasher Opera House. Please let us know if you will accept cash/checks/cards.

Stage Dimensions

Width (inside the proscenium)	24'
Depth (depth without thrust)	16'
Depth (depth with thrust)	19'

Stage Draperies

- 1 - Grand Drape Red - Stage Right Pulley
- 1 - Back Curtain Black - Stage Right Pulley
- 1 - White Wall - Stationary

Audio System

Control/Playback (FOH)

- 1 - Allen & Heath GL2800 32 input/8 output
- 6 - Aux Mixes for monitors (we can accommodate in-ear mixes)
- 1 - Snake 32x8 (various drop snakes available)
- 1 - TC Electronic M 3000
- 1 - TC Electronic M ONE
- 1 - Darwarmer DL441
- 1 - BSS DPR 422
- 1 - BSS DPR 944
- 1 - APHEX 106
- 2 - DBX 166 XL
- 2 - Symetrix 562E
- 1 - Klark Teknik DN370
- 6 - Yamaha 2031
- 1/8" plug is available for phones/tablets/computer/mp3 players
- We can accommodate Spotify playlists

Loudspeakers (FOH) (2018 Install)

- 2 - Danley SM96 Flown
- 2 - Initial Sound Custom Subs



Stage Monitors

- 8 - Turbosound – TFM 122-M (wedge)
- 1 - Electro-Voice ELX118P Subwoofer
- 1 - Electro-Voice ELX112P Powered Speaker

Microphones

- 5 - Shure SM58
- 4 - Shure SM57
- 4 – Crown CM700
- 4 – Sennheiser E906
- 4 – Shure Beta 87 (Wireless Handheld)
- 2 – Shure SM86
- 2 – Shure Beta 58
- 2 – Beyerdynamic M88
- 2 – Beyerdynamic M201
- 2 – Beyerdynamic M160
- 2 – Crown PCC160

- 4 – Countryman DI Boxes (Active DI)
- 2 – Radial JDI (passive)

Cables & Stands & Stage Power

- XLR cables of various lengths
- Microphone stands and booms of various sizes
- AC Stage Power

Lighting System (See Light Plot Below)

Control

- 1 – ETC ColorSource 40AV (2022 Install)
- 1 – Strand MX (Not in use)

Dimming

- 1 – ETC Echo Relay Panel (2022 Install)
 - 120/208V 3P 4W+G MLO includes 12 1-pole relays & 12 1-pole breakers

Lighting Inventory (See Light Plot Below)

Balcony/FOH

- 6 – ETC ColorSource LED 14° barrel (w/diffuser) 5 pin DMX (2022 install)

Stage {3 Electrics}

- 9 – ETC ColorSource LED (w/diffuser) 5 pin DMX (2022 install)

Cyc

- 4 – ETC ColorSource Cyc LED 5 pin DMX (2022 install)

Moving Heads



4 – Chauvet Professional Maverick Force S Spot 5 pin DMX (2022 install)
Spotlights
2 - Lycian Midget 2K 1907

Projection

Panasonic PT L6600 UL with VGA
USB-C to VGA Adapter
The screen that drops in front of the stage (motorized) controls Stage Right

Backline

Drums

Yamaha Stage Custom
Bass drum 22"
Snare 14"
Toms 12" & 14"

Cymbals

Zildjian A Custom Set
Hi Hat 14"
Crash 16" & 18"
Medium Ride 20"
Zildjian Ping ride 20"
Zildjian Thin Crash 17"

Cajons

LP Black Box
On Stage Fixed Snare (has adjustment key)

Piano

Steinway Grand, Model B (7')

Keyboards

NORD-Electro 6D-73

Amplifiers

SWR Black Beauty Bass Combo (400W)
Fender Deluxe Combo
Fender VibroLux Combo

Miscellaneous

Guitar Stands
Amp Tip ups





Parking Information

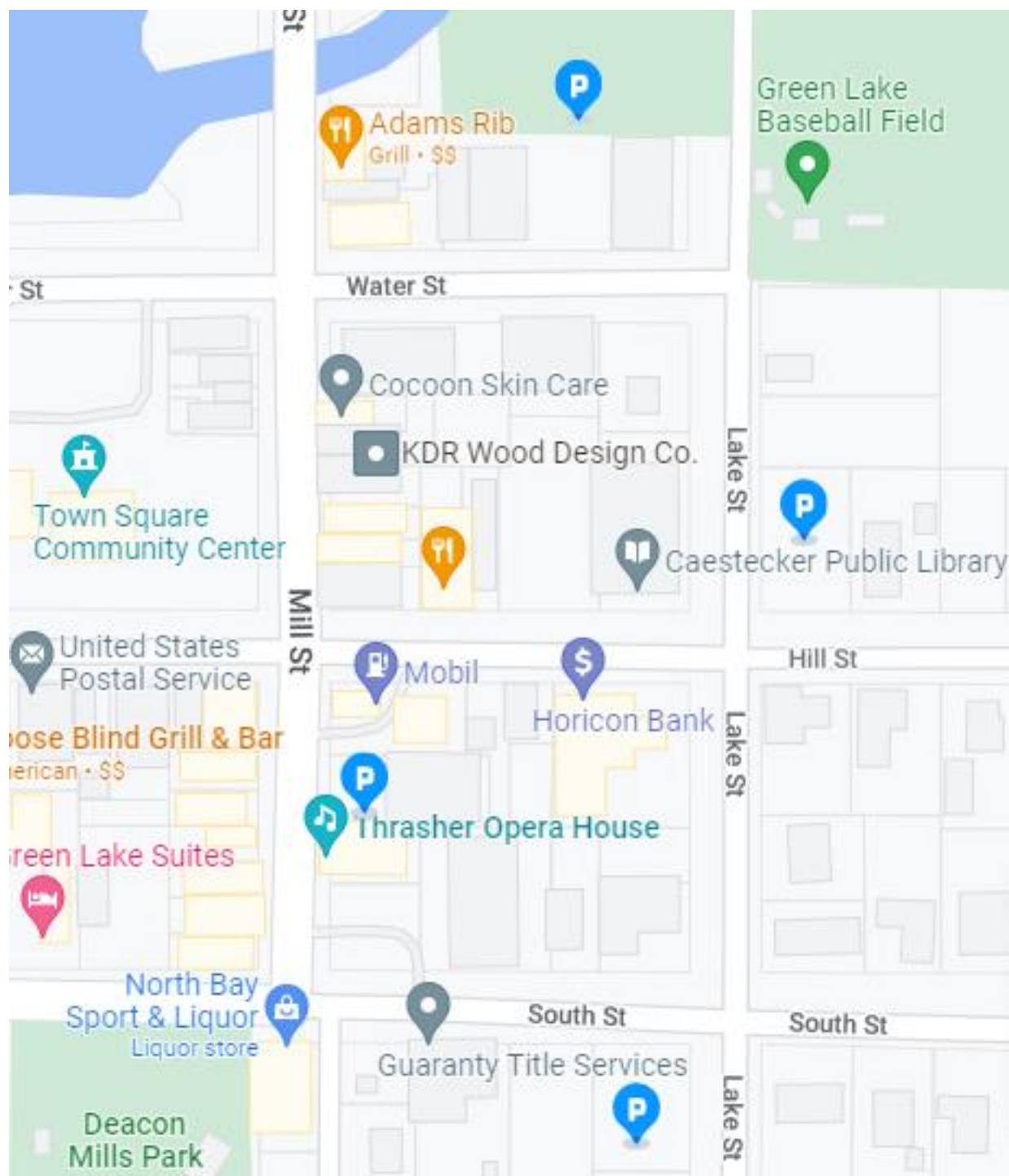



Historical Notes

- Space was originally built in 1910 by Charlie Thrasher, for local performances, vaudeville theater, and silent movies.
- Underwent a major renovation and re-opened in 1998.
- Our facility is listed on the National Historic Site registry.

Accommodations & Services

Heidel House - 1.3 miles to Thrasher

653 Illinois Ave. Green Lake, WI 54941 920.807.0300

Bayview Motel & Marina – 0.4 miles to Thrasher

439 Lake Street, Green Lake, WI 54971 920.294.6504

Super 8 Motel – 8.3 miles to Thrasher

227 Ripon Road. Berlin, WI 54923 800.454.3509

Police

Emergency 911 or 920.294.6333

Hospital

Ripon Community Hospital – 845 Parkside St. Ripon, WI 54971

ThedaCare Medical Center – 225 Memorial Dr. Berlin, WI 54923

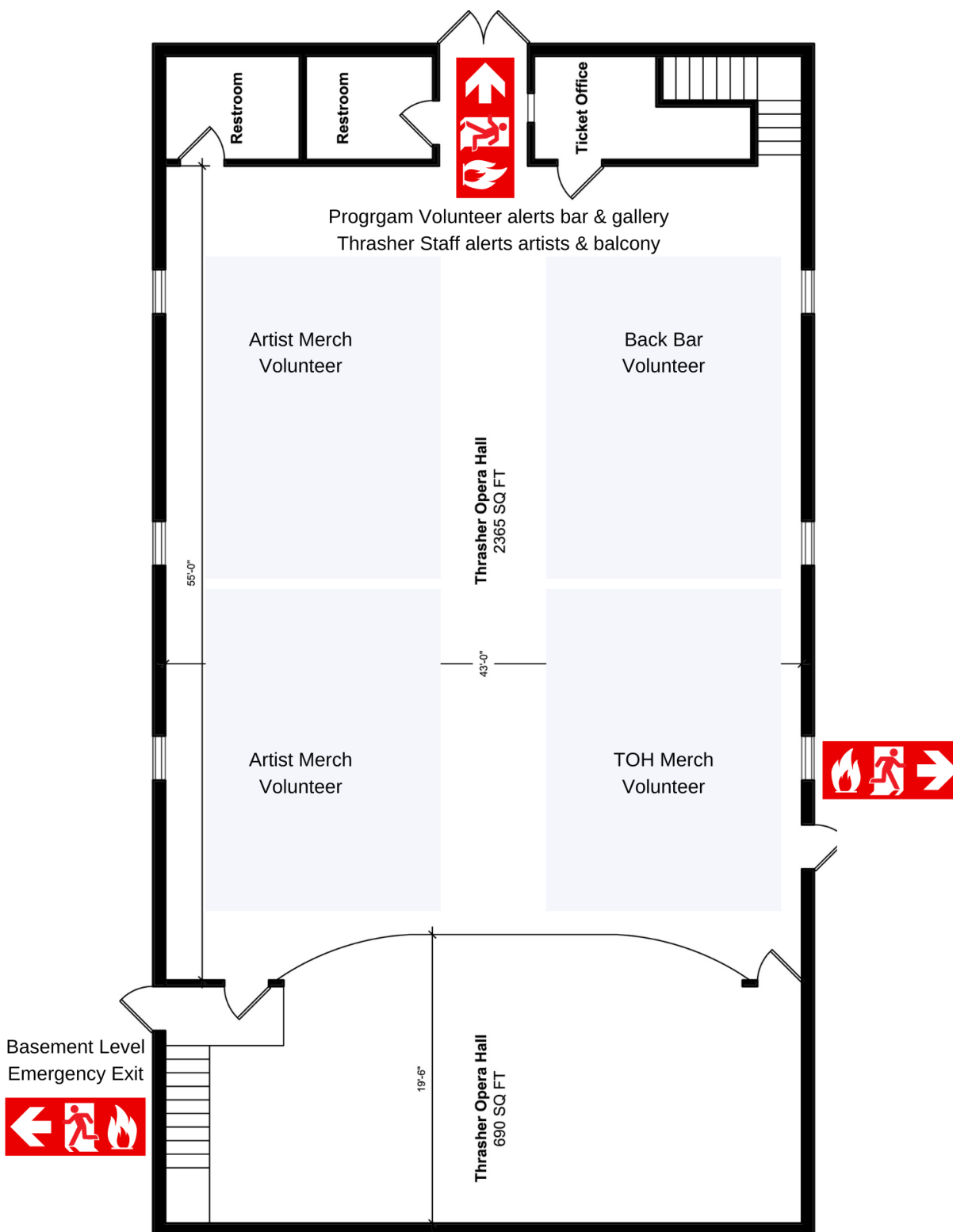



Emergency Route to Deacon Mills Park from Thrasher Opera House

